

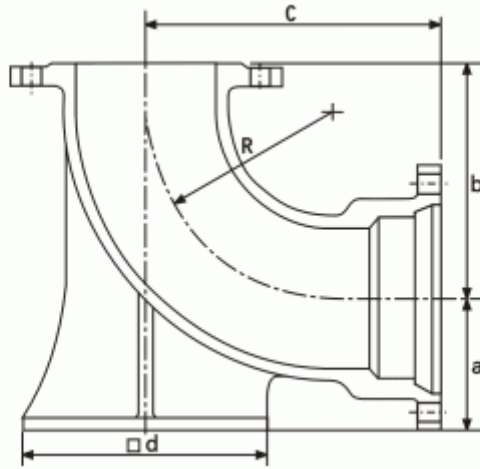

Type A 90° Duckfoot Bend with Flange and Socket



Nominal size	Thickness	a	b	c	d	R	Weight (kg)
100	8.5	116.0	197	256.5	200	150	25.0
150	9.0	143.5	248	306.5	250	200	40.0

Unit: mm

Note: 1. Working pressure: 7.5 kg/cm².

2. The dimensions of flanges shall be in accordance with JIS G5527 7.5 kg/cm².